

SHIP SPECIFICATIONS

SPIRIT OF ENDERBY



Passengers	Staff & Crew	Length	Breadth	Draft	Lifeboats	Propulsion	Speed	Ice Class	Registered
50	32	69.7m	12.8m	4.5m	2 Fully Enclosed	2x1560 bnp	10 knots	1A	Russia



The Ship:

The Spirit of Enderby is a fully ice-strengthened expedition vessel, built in 1984 for Polar and oceanographic research. She carries 50 passengers and was last refurbished in 2013 to provide comfortable accommodation in twin share cabins. All cabins have outside windows or portholes and ample storage space. On board there is a combined bar, library and lounge area and a dedicated lecture room. The cuisine is excellent and prepared by top chefs.

On Board:

- Expert naturalists and historians
- Access to bridge available 24 hours
- 28 cabins, all with exterior views
- Cabins have either shared or private facilities
 - Theatre style presentation room
- Two dining rooms with unreserved seating
 - Lounge and bar library area
 - Coffee and tea available 24 hours
- Ship-to-shore communication via satellite
 - Infirmary with Medical Advisor
 - Sauna

Deck Plan:

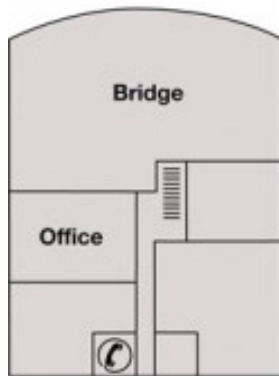

TOP DECK

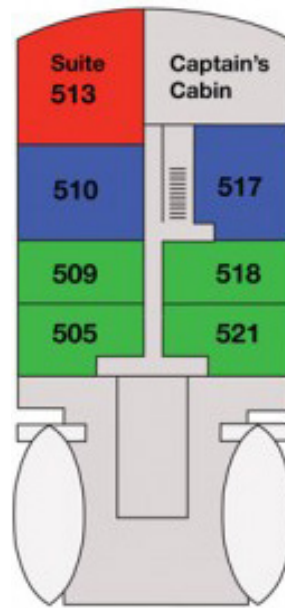

UPPER DECK

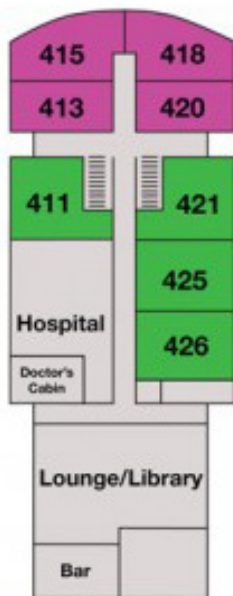
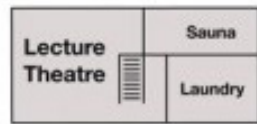

MIDDLE DECK

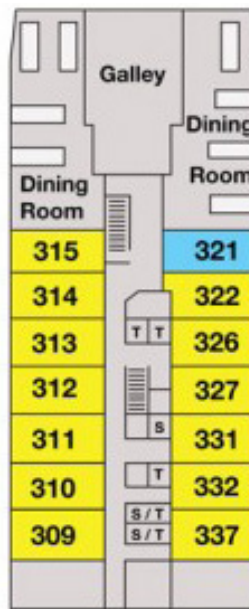

MAIN DECK



LOWER DECK

■ HERITAGE SUITE

■ SUPERIOR PLUS

■ MAIN DECK

■ MINI SUITE

■ SUPERIOR

■ MAIN DECK TRIPLE



Cabin Class:

Heritage Suite: The Heritage Suite has a large lounge area, a separate bedroom with double bed, a single bed in the lounge, writing desk, wardrobe and drawers. There is a private bathroom with shower, toilet and washbasin. There are large forward and side facing windows to allow great views.

Mini Suite: These cabins have separate bedrooms with a double bed and a single bed (or a sofa in the lounge), wardrobe, drawers, a desk and a private bathroom with shower, toilet and washbasin. All Mini Suites have windows.

Superior Plus: There are two lower berths, a wardrobe, drawers, desk, private bathroom with shower, toilet and washbasin. All Superior Plus cabins have windows.

Superior: These cabins have bunks (an upper and lower berth), a wardrobe, drawers, a desk, a private bathroom with shower, toilet and washbasin. All Superior cabins have windows.

Main Deck: The Main Deck cabins have two lower berths, a wardrobe, drawers, desk, washbasin and porthole. The nearby showers and toilets are shared with other Main Deck cabins.

Main Deck Triple: Triple cabins have one bunk (one upper and one lower) and one lower berth, a wardrobe, drawers, a desk and a wash basin. The nearby showers and toilets are shared with other Main Deck cabins. Please be aware that Main Deck Triple cabins are not available on all departures.